

**milenyum metal**

## What MILENYUM METAL can do for customers?

**MILENYUM METAL** has been developing and producing **ironing boards, cloth dryers, and metal houseware products** since 2003 in Kayseri Free Zone / TURKEY and has thus acquired an extensive expertise in production. We added new category **Metal Furniture; bunk bed and metal bed** to our production line in 2014.

Due to increasing demand, we enlarged our total production area from 7.200 m<sup>2</sup> of covered off area to 18.000 m<sup>2</sup> with our new factory in 2015, and in 2022 with our new construction we enlarged our covered off area to 25.000 m<sup>2</sup>. Having based ourselves on the features demanded by large companies, we have created innovative, user-friendly applications.

**MILENYUM METAL** has been named one of Turkey's leading companies exporting in **45 countries** all over the world. Our main goal is to keep striving to have complete customer satisfaction.

Our keen knowledge of production has helped solutions that answer the needs of today's clients and we are implementing **LEAN PRODUCTION** activity at our factory.

**These solutions allow you to:**

- Increase productivity
- Reduce operating cost
- Increase customer satisfaction
- Innovative and Quality Products

Our company has SMETA Audit, and also we have INTERTEK/GS certificate for our ironing board models.





## Our Goal

We love people and care about our planet, so we produce housewares product to the life simple.

## Our Vision

Increase the quality of life through innovation by using natural resources efficiently.



triikimis

daska za pegl

гладильная

planc

mesa

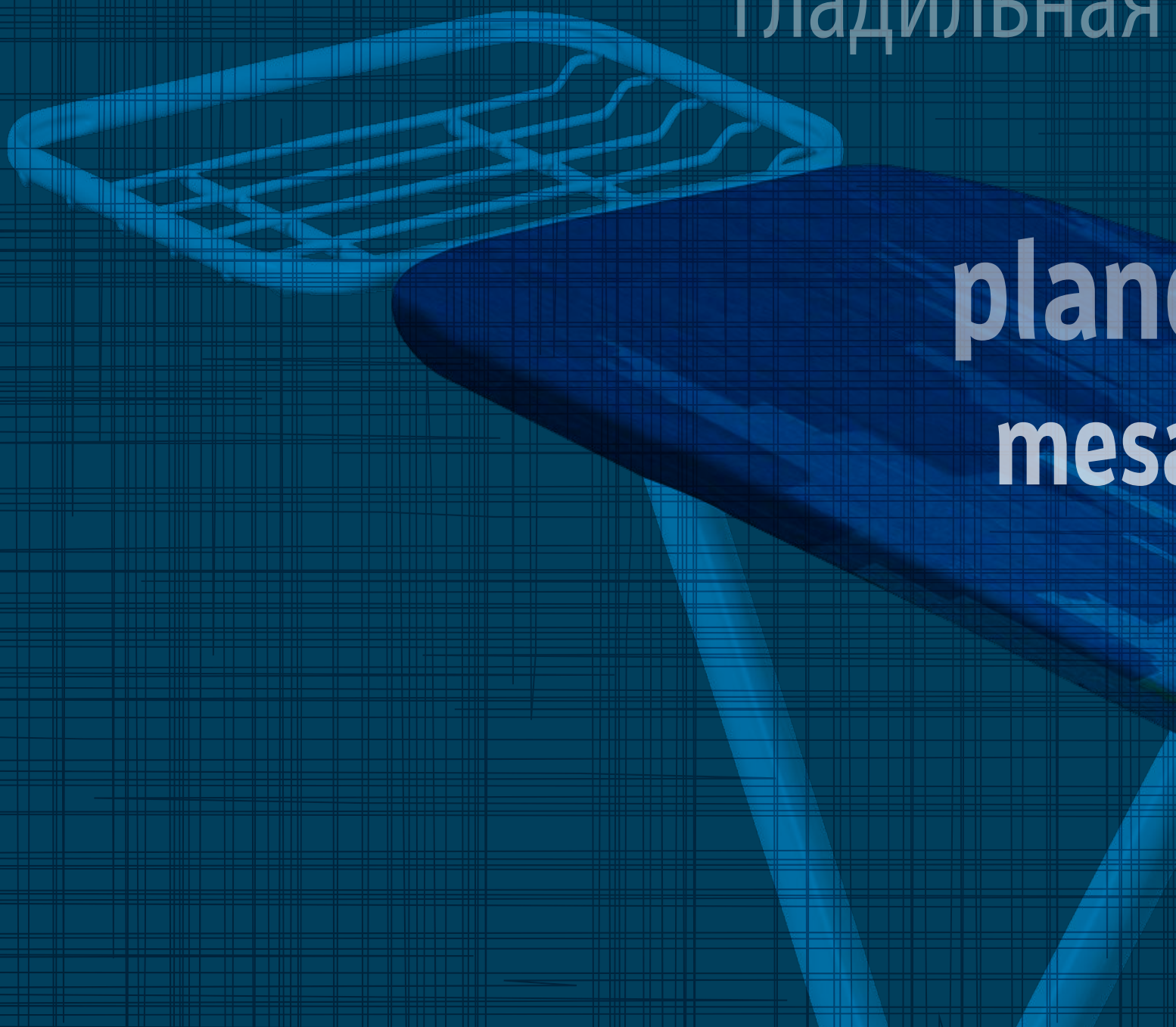



طاولة الكي  
table de planchar  
silityslauta  
ütü masası  
**ironing board**  
che à repasser  
a de engomar  
žehliaca doska  
доска за пеглање

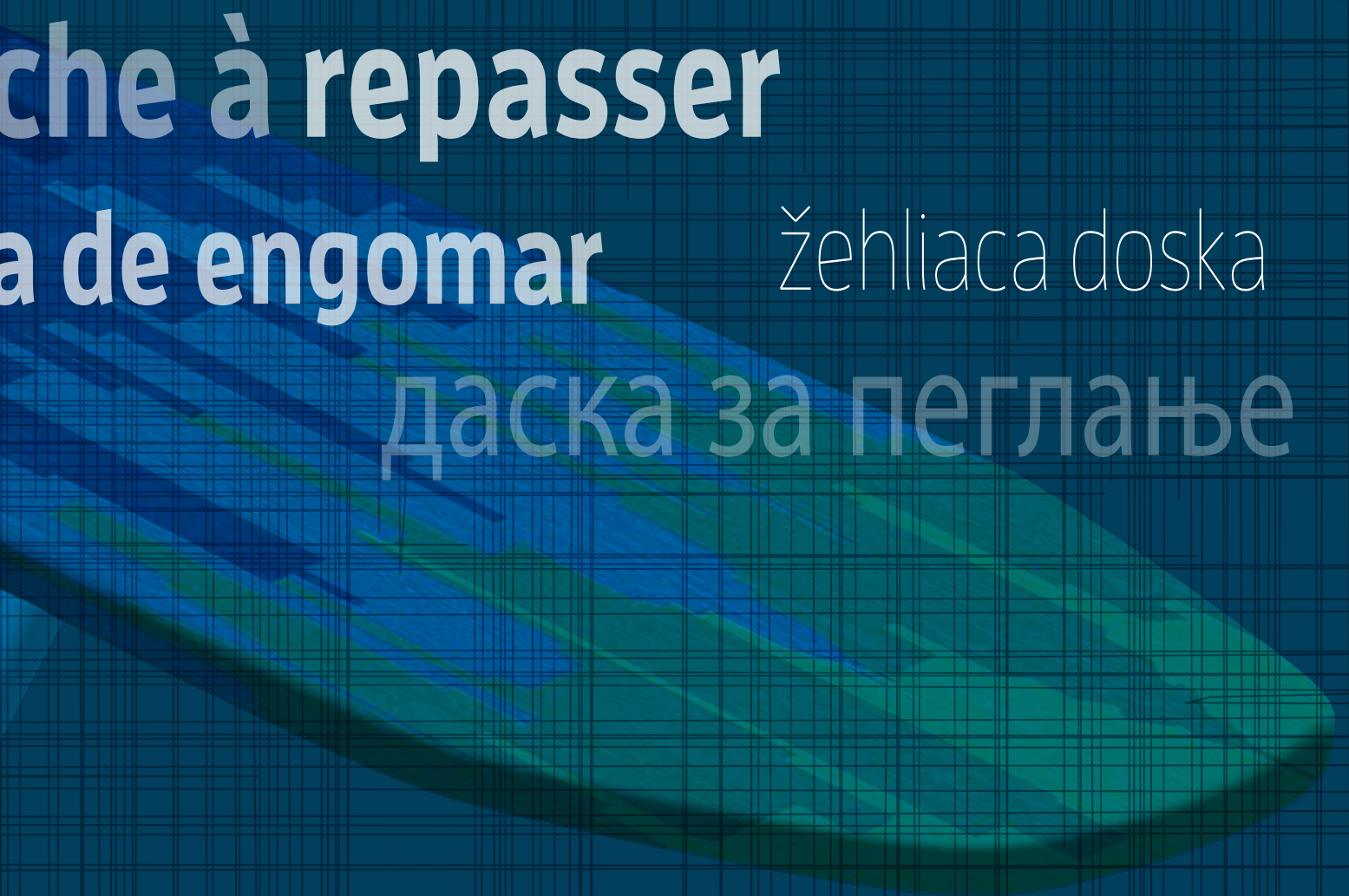

# BASIC IRONING BOARD



## BOARD SIZE (CM)

MESH - 34x97

## LEGS (MM)

ø 19

## Technical Specifications

- Mesh ironing board with safety iron rest with silicon dots
- Variable adjustment from 68 cm up to 83 cm
- Powder coating
- 100% cotton with 8 mm foam pad
- Shrink wrap with colour label & outer carton box



**PRODUCT HEIGHT**  
Max. 83 cm  
Min. 68 cm



**PRODUCT WEIGHT**  
3,65 KG



**PACKAGE WEIGHT**  
15,80 KG



**PACKAGE SIZE**  
140x35x21 CM



**PIECES IN BOX**  
4



**PCS / 20"FT**  
1152



**PCS / 40"FT**  
2484



**TRUCK**  
3268



## IRONING BOARD

# BEETLE



### BOARD SIZE (CM)

MESH - 34x97

### LEGS (MM)

ø 25x21

### Technical Specifications

- Mesh ironing board with safety iron rest with silicon dots
- Variable adjustment from 72 cm up to 87 cm
- Powder coating
- 100% cotton with 8 mm foam pad
- Shrink wrap with colour label & outer carton box



**PRODUCT HEIGHT**

Max. 87 cm  
Min. 72 cm



**PRODUCT WEIGHT**

3,45 KG



**PACKAGE WEIGHT**

15,00 KG



**PACKAGE SIZE**

145x38x22 CM



**PIECES IN BOX**

4



**PCS / 20'FT**

920



**PCS / 40'FT**

2220



**TRUCK**

2664

**milenyum metal**

# JAZZ IRONING BOARD



## BOARD SIZE (CM)

MESH - 34x110

## LEGS (MM)

ø 28x21

## Technical Specifications

- Mesh ironing board with safety iron rest with silicon dots
- Variable adjustment from 80 cm up to 94 cm
- Powder coating
- 100% cotton with 8 mm foam pad
- Shrink wrap with colour label & outer carton box



**PRODUCT HEIGHT**  
Max. 94 cm  
Min. 80 cm



**PRODUCT WEIGHT**  
3,90 KG



**PACKAGE WEIGHT**  
16,80 KG



**PACKAGE SIZE**  
151x38x22 CM



**PIECES IN BOX**  
4



**PCS / 20"FT**  
888



**PCS / 40"FT**  
2160



**TRUCK**  
2590



IRONING  
BOARD

PRATIK



#### BOARD SIZE (CM)

MESH - 34x110

#### LEGS (MM)

ø 21

#### Technical Specifications

- Mesh ironing board with safety iron rest with silicon dots
- Variable adjustment from 75 cm up to 89 cm
- Powder coating
- 100% cotton with 8 mm foam pad
- Shrink wrap with colour label & outer carton box



**PRODUCT HEIGHT**  
Max. 89 cm  
Min. 75 cm



**PRODUCT WEIGHT**  
3,90 KG



**PACKAGE WEIGHT**  
16,80 KG



**PACKAGE SIZE**  
140x39x22 CM



**PIECES IN BOX**  
4



**PCS / 20"FT**  
900



**PCS / 40"FT**  
2236



**TRUCK**  
2740

milenyum metal

# FUNKY IRONING BOARD



## BOARD SIZE (CM)

MESH - 34x110

## LEGS (MM)

ø 19

## Technical Specifications

- Mesh ironing board with safety iron rest with silicon dots
- Variable adjustment from 68 cm up to 83 cm
- Powder coating
- 100% cotton with 8 mm foam pad
- Shrink wrap with colour label & outer carton box



**PRODUCT HEIGHT**  
Max. 83 cm  
Min. 68 cm



**PRODUCT WEIGHT**  
3,85 KG



**PACKAGE WEIGHT**  
16,60 KG



**PACKAGE SIZE**  
140x35x21 CM



**PIECES IN BOX**  
4



**PCS / 20'FT**  
1152



**PCS / 40'FT**  
2484



**TRUCK**  
3268



## IRONING BOARD

# FUNKY S

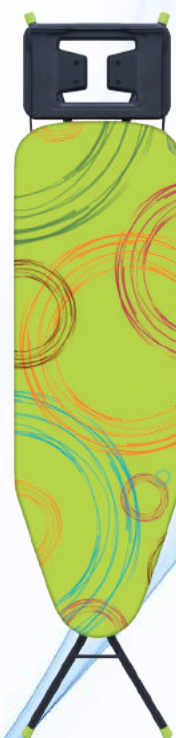

### BOARD SIZE (CM)

MESH - 34x110

### LEGS (MM)

Ø 19

### Technical Specifications

- Mesh ironing board with safety iron rest with silicon dots
- Variable adjustment from 75 cm up to 92 cm
- Powder coating
- 100% cotton with 8 mm foam pad
- Shrink wrap with colour label & outer carton box



**PRODUCT HEIGHT**

Max. 92 cm  
Min. 75 cm



**PRODUCT WEIGHT**

4,10 KG



**PACKAGE WEIGHT**

17,60 KG



**PACKAGE SIZE**

159x35x22 CM



**PIECES IN BOX**

4



**PCS / 20'FT**

912



**PCS / 40'FT**

2160



**TRUCK**

2728

**milenyum metal**

# STYLISH

## IRONING BOARD



### BOARD SIZE (CM)

MESH - 36x115

### LEGS (MM)

Ø 28x28

### Technical Specifications

- Mesh ironing board without iron rest
- Variable adjustment from 67 cm up to 81 cm
- Powder coating
- 100% cotton with 8 mm foam pad
- Shrink wrap with colour label & outer carton box



**PRODUCT HEIGHT**  
Max. 81 cm  
Min. 67 cm



**PRODUCT WEIGHT**  
3,75 KG



**PACKAGE WEIGHT**  
16,20 KG



**PACKAGE SIZE**  
128x38x22 CM



**PIECES IN BOX**  
4



**PCS / 20'FT**  
1040



**PCS / 40'FT**  
2464



**TRUCK**  
3348



IRONING  
BOARD

**STYLISH PREMIUM**



**BOARD SIZE (CM)**

MESH - 34x134

**LEGS (MM)**

ø 28x28

**Technical Specifications**

- Mesh ironing board without iron rest
- Variable adjustment from 75 cm up to 89 cm
- Powder coating
- 100% cotton with 8 mm foam pad
- Shrink wrap with colour label & outer carton box



**PRODUCT HEIGHT**

Max. 89 cm  
Min. 75 cm



**PRODUCT WEIGHT**

3,90 KG



**PACKAGE WEIGHT**

16,80 KG



**PACKAGE SIZE**

143x40x24 CM



**PIECES IN BOX**

4



**PCS / 20"FT**

800



**PCS / 40"FT**

1960



**TRUCK**

2500

# STYLISH ELEGANCE

## IRONING BOARD



### BOARD SIZE (CM)

MESH - 34x134

### LEGS (MM)

ø 32x38

### Technical Specifications

- Mesh ironing board without iron rest
- Variable adjustment from 75 cm up to 89 cm
- Powder coating
- 100% cotton with 8 mm foam pad
- Shrink wrap with colour label & outer carton box



**PRODUCT HEIGHT**  
Max. 89 cm  
Min. 75 cm



**PRODUCT WEIGHT**  
4,55 KG



**PACKAGE WEIGHT**  
19,40 KG



**PACKAGE SIZE**  
145x43x29 CM



**PIECES IN BOX**  
4



**PCS / 20'FT**  
600



**PCS / 40'FT**  
1536



**TRUCK**  
1820



## IRONING BOARD

# ANGELO



### BOARD SIZE (CM)

MESH - 38x120

### LEGS (MM)

ø 21

### Technical Specifications

- Mesh ironing board with safety iron rest with silicon dots
- Variable adjustment from 78 cm up to 94 cm
- Powder coating
- 100% cotton with 8 mm foam pad
- Shrink wrap with colour label & outer carton box



PRODUCT HEIGHT	PRODUCT WEIGHT	PACKAGE WEIGHT	PACKAGE SIZE	PIECES IN BOX	PCS / 20'FT	PCS / 40'FT	TRUCK
Max. 94 cm Min. 78 cm	4,30 KG	18,40 KG	158x39x22 CM	4	820	1920	2552

# DAISY IRONING BOARD



## BOARD SIZE (CM)

MESH - 38x120

## LEGS (MM)

ø 25

## Technical Specifications

- Mesh ironing board with safety iron rest with silicon dots
- Variable adjustment from 78 cm up to 94 cm
- Powder coating
- 100% cotton with 8 mm foam pad
- Shrink wrap with colour label & outer carton box



**PRODUCT HEIGHT**  
Max. 94 cm  
Min. 78 cm



**PRODUCT WEIGHT**  
5,10 KG



**PACKAGE WEIGHT**  
21,60 KG



**PACKAGE SIZE**  
158x39x24 CM



**PIECES IN BOX**  
4



**PCS / 20'FT**  
720



**PCS / 40'FT**  
1780



**TRUCK**  
2332



# IRONING BOARD

## CLASSIC



### BOARD SIZE (CM)

MESH - 38x120

### LEGS (MM)

ø 20x30

### Technical Specifications

- Mesh ironing board with safety iron rest with silicon dots
- Variable adjustment from 80 cm up to 95 cm
- Powder coating
- 100% cotton with 8 mm foam pad
- Shrink wrap with colour label & outer carton box



**PRODUCT HEIGHT**  
Max. 95 cm  
Min. 80 cm



**PRODUCT WEIGHT**  
5,25 KG



**PACKAGE WEIGHT**  
22,20 KG



**PACKAGE SIZE**  
158x39x25 CM



**PIECES IN BOX**  
4



**PCS / 20"FT**  
680



**PCS / 40"FT**  
1724



**TRUCK**  
2240

**milenyum metal**

# SPRING S IRONING BOARD



## BOARD SIZE (CM)

MESH - 38x110

## LEGS (MM)

ø 32x32

## Technical Specifications

- Mesh ironing board with steam station iron rest with silicon dots
- Variable adjustment from 74 cm up to 90 cm
- Powder coating
- 100% cotton with 8 mm foam pad
- Shrink wrap with colour label & outer carton box



**PRODUCT HEIGHT**  
Max. 90 cm  
Min. 74 cm



**PRODUCT WEIGHT**  
5,40 KG



**PACKAGE WEIGHT**  
12,00 KG



**PACKAGE SIZE**  
153x44x16 CM



**PIECES IN BOX**  
2



**PCS / 20'FT**  
500



**PCS / 40'FT**  
1200



**TRUCK**  
1550



IRONING  
BOARD

MAGIC



**BOARD SIZE (CM)**

MESH - 38x124

**LEGS (MM)**

ø 21x32 / 32

**Technical Specifications**

- Mesh ironing board with safety iron rest with silicon dots
- Variable adjustment from 78 cm up to 95 cm
- Powder coating
- 100% cotton with 8 mm foam pad
- Shrink wrap with colour label & outer carton box

PRODUCT HEIGHT	PRODUCT WEIGHT	PACKAGE WEIGHT	PACKAGE SIZE	PIECES IN BOX	PCS / 20'FT	PCS / 40'FT	TRUCK
Max. 95 cm Min. 78 cm	5,00 KG	11,00 KG	163x40x19 CM	2	438	1102	1380

# PASSION S

## IRONING BOARD



### BOARD SIZE (CM)

MESH - 38x120

### LEGS (MM)

ø 25

### Technical Specifications

- Mesh ironing board with safety iron rest with silicon dots
- Variable adjustment from 78 cm up to 94 cm
- Powder coating
- 100% cotton with 8 mm foam pad
- Shrink wrap with colour label & outer carton box



**PRODUCT HEIGHT**  
Max. 94 cm  
Min. 78 cm



**PRODUCT WEIGHT**  
5,75 KG



**PACKAGE WEIGHT**  
12,50 KG



**PACKAGE SIZE**  
164x44x13,2 CM



**PIECES IN BOX**  
2



**PCS / 20'FT**  
586



**PCS / 40'FT**  
1394



**TRUCK**  
1820

## IRONING BOARD

## NEO S



### BOARD SIZE (CM)

MESH - 38x120

### LEGS (MM)

ø 20X30

### Technical Specifications

- Mesh ironing board with steam station iron rest with silicon dots
- Variable adjustment from 80 cm up to 95 cm
- Powder coating
- 100% cotton with 8 mm foam pad
- Shrink wrap with colour label & outer carton box



**PRODUCT HEIGHT**  
Max. 95 cm  
Min. 80 cm



**PRODUCT WEIGHT**  
6,00 KG



**PACKAGE WEIGHT**  
13,00 KG



**PACKAGE SIZE**  
164x44x14,3 CM



**PIECES IN BOX**  
2



**PCS / 20'FT**  
558



**PCS / 40'FT**  
1312



**TRUCK**  
1652



# STELLA S

## IRONING BOARD

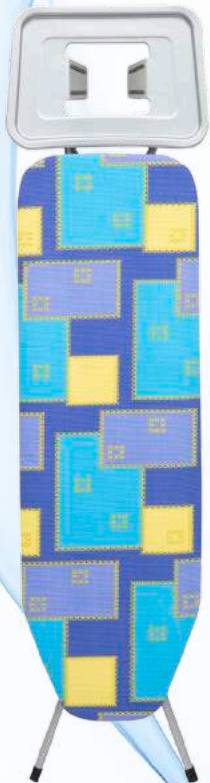

### BOARD SIZE (CM)

MESH - 38x120

### LEGS (MM)

ø 19x34

### Technical Specifications

- Mesh ironing board with steam station iron rest with silicon dots
- Variable adjustment from 80 cm up to 95 cm
- Powder coating
- 100% cotton with 8 mm foam pad
- Shrink wrap with colour label & outer carton box



**PRODUCT HEIGHT**  
Max. 95 cm  
Min. 80 cm



**PRODUCT WEIGHT**  
6.40 KG



**PACKAGE WEIGHT**  
13.80 KG



**PACKAGE SIZE**  
164x44x14,3 CM



**PIECES IN BOX**  
2



**PCS / 20"FT**  
558



**PCS / 40"FT**  
1312



**TRUCK**  
1652

IRONING  
BOARD

STAR



#### BOARD SIZE (CM)

MESH - 38x120

#### LEGS (MM)

ø 19x34/38

#### Technical Specifications

- Mesh ironing board with safety iron rest with silicon dots
- Variable adjustment from 71 cm up to 94 cm
- Powder coating
- 100% cotton with 8 mm foam pad
- Shrink wrap with colour label & outer carton box

PRODUCT HEIGHT	PRODUCT WEIGHT	PACKAGE WEIGHT	PACKAGE SIZE	PIECES IN BOX	PCS / 20'FT	PCS / 40'FT	TRUCK
Max. 94 cm Min. 71 cm	7,00 KG	15,50 KG	160x50x20 CM	2	332	800	988

# CARINA S

## IRONING BOARD



### BOARD SIZE (CM)

MESH - 45x125

### LEGS (MM)

Ø 20x30

### Technical Specifications

- Mesh ironing board with steam station iron rest with silicon dots
- Variable adjustment from 80 cm up to 95 cm
- Powder coating
- 100% cotton with 8 mm foam pad
- Shrink wrap with colour label & outer carton box



**PRODUCT HEIGHT**  
Max. 95 cm  
Min. 80 cm



**PRODUCT WEIGHT**  
6,50 KG



**PACKAGE WEIGHT**  
14,00 KG



**PACKAGE SIZE**  
165x46,5x14,3 CM



**PIECES IN BOX**  
2



**PCS / 20"FT**  
520



**PCS / 40"FT**  
1248



**TRUCK**  
1618



# IRONING BOARD

## PEARL S



### BOARD SIZE (CM)

MESH - 45x125

### LEGS (MM)

ø 19x34

### Technical Specifications

- Mesh ironing board with steam station iron rest with silicon dots
- Variable adjustment from 80 cm up to 95 cm
- Powder coating
- 100% cotton with 8 mm foam pad
- Shrink wrap with colour label & outer carton box

PRODUCT HEIGHT	PRODUCT WEIGHT	PACKAGE WEIGHT	PACKAGE SIZE	PIECES IN BOX	PCS / 20'FT	PCS / 40'FT	TRUCK
Max. 95 cm Min. 80 cm	6,90 KG	14,80 KG	165x46,5x14,3 CM	2	520	1248	1618

# PASSAT-S

## IRONING BOARD



### BOARD SIZE (CM)

MESH - 45x120

### LEGS (MM)

ø 19x34 / 38

### Technical Specifications

- Mesh ironing board with steam station iron rest with silicon dots
- Variable adjustment from 71 cm up to 94 cm
- Powder coating
- 100% cotton with 8 mm foam pad
- Shrink wrap with colour label & outer carton box



**PRODUCT HEIGHT**  
Max. 94 cm  
Min. 71 cm



**PRODUCT WEIGHT**  
8,00 KG



**PACKAGE WEIGHT**  
17,50 KG



**PACKAGE SIZE**  
163x51x21 CM



**PIECES IN BOX**  
2



**PCS / 20'FT**  
340



**PCS / 40'FT**  
790



**TRUCK**  
952

IRONING  
BOARD

## TABLE TOP



### BOARD SIZE (CM)

MESH - 34x75

### LEGS (MM)

ø 6

### Technical Specifications

- Mesh ironing board
- Hanger hook - 7 mm wire
- Powder coating
- 100% cotton with 8 mm foam pad
- Shrink wrap with colour label & outer carton box



PRODUCT HEIGHT  
15 CM



PRODUCT WEIGHT  
1,60 KG



PACKAGE WEIGHT  
10,20 KG



PACKAGE SIZE  
76x36x21 CM



PIECES IN BOX  
6



PCS / 20'FT  
2790



PCS / 40'FT  
6318



TRUCK  
7950

milenyum metal





# LUGGAGE RACK

LR-S-001



LR-S-002



## Technical Specifications

- Square tube steel construction adds strength and durability
- Powder coat finish with wide black straps is perfect for most any guest room decor
- Lightweight and folds easily for quick storage
- Bubble nylon wrap with outer carton box



MODEL	PACKAGE WEIGHT	PIECES IN BOX	PACKAGE SIZE	PCS / 20'FT	PCS / 40'FT	TRUCK
LR-S-001	10,80 KG	4	21,7x69x60 CM	1200	2996	3600
LR-S-002	13,20 KG	4	20,7x84,5x60 CM	960	2408	2880







# LUGGAGE RACK

LR-R-001



LR-R-002



### Technical Specifications

- Tubular steel construction adds strength and durability
- Powder coat finish with wide black straps is perfect for most any guest room decor
- Lightweight and folds easily for quick storage
- Bubble nylon wrap with outer carton box



MODEL	PACKAGE WEIGHT	PIECES IN BOX	PACKAGE SIZE	PCS / 20"FT	PCS / 40"FT	TRUCK
LR-R-001	9,40 KG	4	22,3x67,2x60 CM	1200	3008	3600
LR-R-002	11,92 KG	4	24,7x79x60,3 CM	936	2340	2808

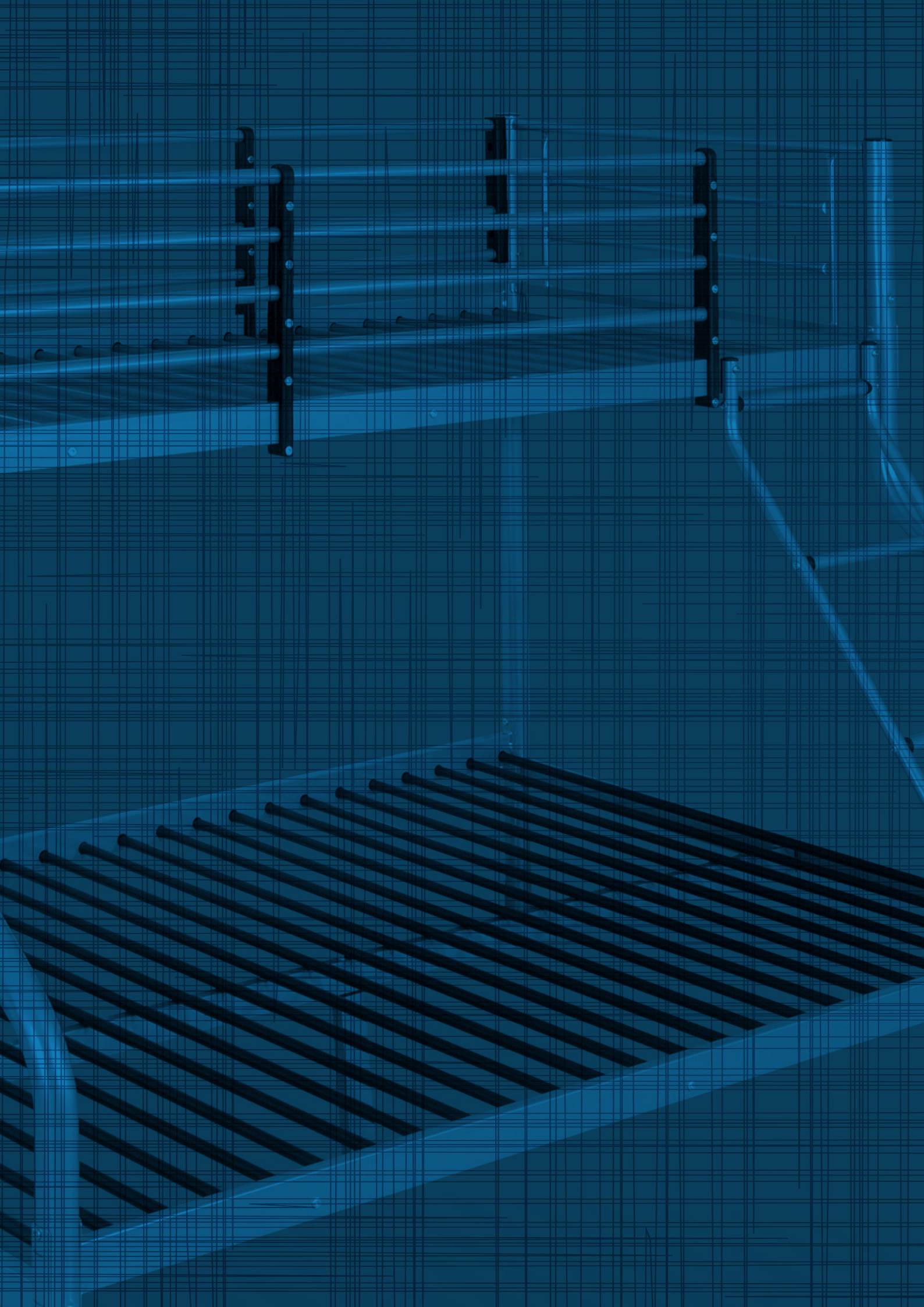



metall  
säng

metallin kerrossänky

سرير معدني

metal ranza beliche de metal

kovová poschodová

metal bunk

metal etagen

metallist nari

superposés en métal

металлическая койка

litera de metal





SCAN  
for product  
video

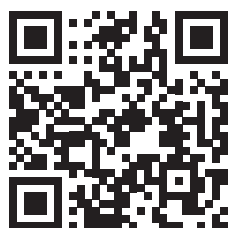

METAL  
BUNK BED

**ALADDIN**



**NEW SLAT SYSTEM  
EASY TO ASSEMBLE**

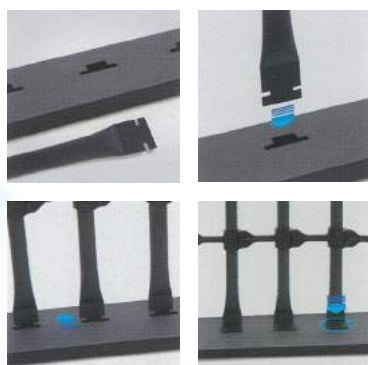

#### Technical Specifications

- Self-Assemble
- 2 Person Needed
- Finished: White / Silver Powder Coating
- Headboard and Footboard is welded
- Slats and Barriers are knockdown
- Packaging: Polybag & Protector Carton & Assembly Instruction & Outer Carton Box

PRODUCT HEIGHT	MODEL SIZE	PIECES IN BOX	PACKAGE WEIGHT	PACKAGE SIZE	PCS / 20"FT	PCS / 40"FT	TRUCK
160 CM	90/140 x 190 CM	1 IN 1	53,50 KG	18x48x197 CM	155	375	440
160 CM	90/140 x 200 CM	1 IN 1	54,00 KG	18x48x207 CM	145	345	410







SCAN  
for product  
video

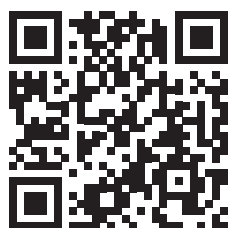

METAL  
BUNK BED

BALMSEMI



NEW SLAT SYSTEM  
EASY TO ASSEMBLE

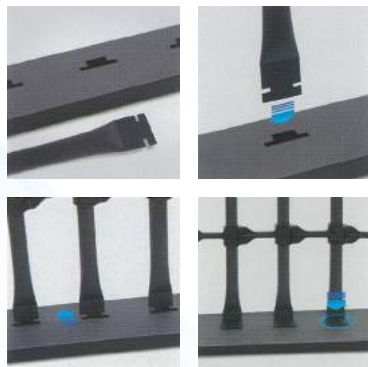

#### Technical Specifications

- Self-Assemble
- 2 Person Needed
- Finished: White / Silver Powder Coating
- Headboard and Footboard is welded
- Slats and Barriers are knockdown
- Packaging: Polybag & Protector Carton & Assembly Instruction & Outer Carton Box

PRODUCT HEIGHT	MODEL SIZE	PIECES IN BOX	PACKAGE WEIGHT	PACKAGE SIZE	PCS / 20"FT	PCS / 40"FT	TRUCK
160 CM	90 x 190 CM	1 IN 1	45,50 KG	18x32x193 CM	240	550	530
160 CM	90 x 200 CM	1 IN 1	46,00 KG	18x32x203 CM	230	530	515





SCAN  
for product  
video

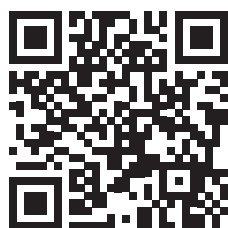

METAL  
BUNK BED

**BALMEASE**





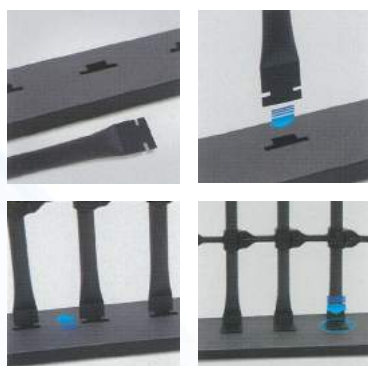





**NEW SLAT SYSTEM  
EASY TO ASSEMBLE**



#### Technical Specifications

- Self-Assemble
- 2 Person Needed
- Finished: White / Silver Powder Coating  
Headboard, Footboard, Slats  
and Barriers are knockdown
- Packaging: Polybag & Protector Carton &  
Assembly Instruction & Outer Carton Box

							
PRODUCT HEIGHT	MODEL SIZE	PIECES IN BOX	PACKAGE WEIGHT	PACKAGE SIZE	PCS / 20'FT	PCS / 40'FT	TRUCK
160 CM	90 x 190 CM	1 IN 1	44,50 KG	16x30x192 CM	290	640	510
160 CM	90 x 200 CM	1 IN 1	45,00 KG	16x30x202 CM	275	620	500





SCAN  
for product  
video

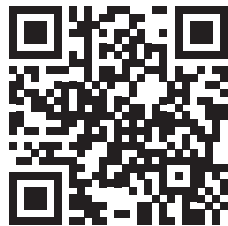

METAL  
BUNK BED

# BONOEASE



NEW SLAT SYSTEM  
EASY TO ASSEMBLE

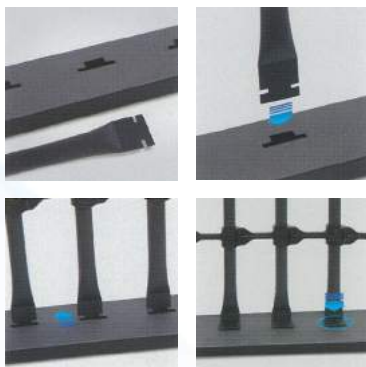

## Technical Specifications

- Self-Assemble
- 2 Person Needed
- Finished: White / Silver Powder Coating  
Headboard, Footboard, Slats and  
Barriers are knockdown
- Packaging: Polybag & Protector Carton &  
Assembly Instruction & Outer Carton Box

PRODUCT HEIGHT	MODEL SIZE	PIECES IN BOX	PACKAGE WEIGHT	PACKAGE SIZE	PCS / 20"FT	PCS / 40"FT	TRUCK
185 CM	90 x 190 CM	1 IN 1	36,50 KG	15x30x192 CM	330	680	540
185 CM	90 x 200 CM	1 IN 1	37,00 KG	15x30x202 CM	300	660	520







SCAN  
for product  
video



METAL  
BUNK BED

**BAMBIEASE**

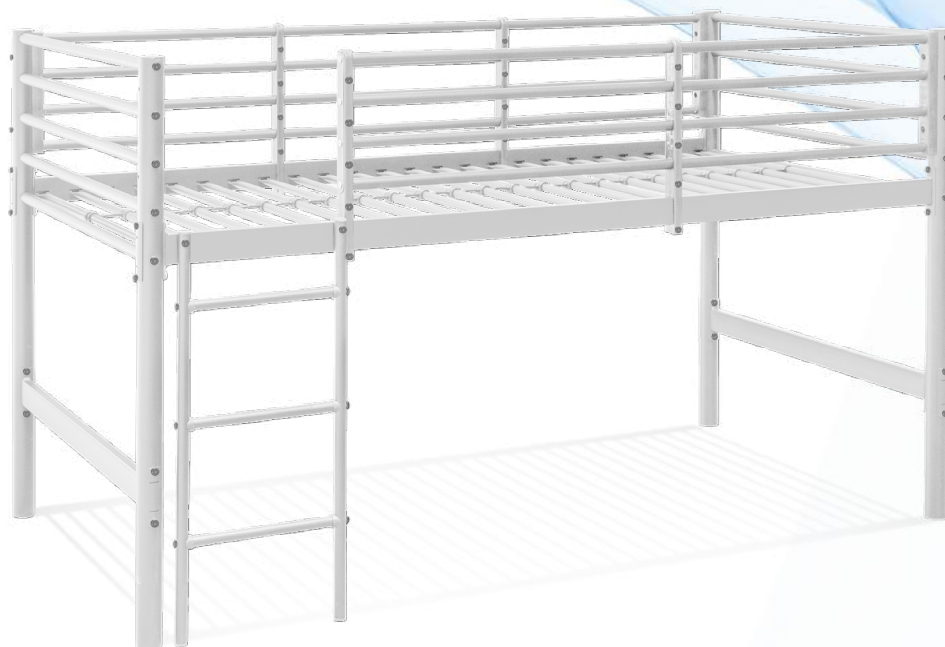

**NEW SLAT SYSTEM  
EASY TO ASSEMBLE**

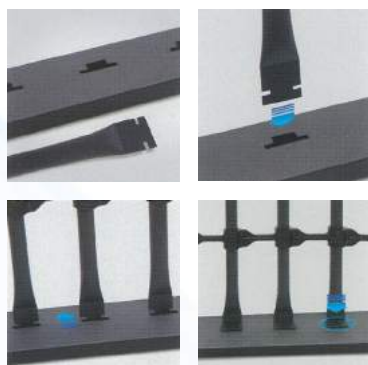

### Technical Specifications

- Self-Assemble
- 2 Person Needed
- Finished: White / Silver Powder Coating
- Headboard, Footboard, Slats and Barriers are knockdown
- Packaging: Polybag & Protector Carton & Assembly Instruction & Outer Carton Box

PRODUCT HEIGHT	MODEL SIZE	PIECES IN BOX	PACKAGE WEIGHT	PACKAGE SIZE	PCS / 20"FT	PCS / 40"FT	TRUCK
115 CM	90 x 190 CM	1 IN 1	31,50 KG	13x30x192 CM	375	870	700
115 CM	90 x 200 CM	1 IN 1	32,00 KG	13x30x202 CM	360	850	670





**METAL  
BUNK BED**

**GENOA**



**NEW SLAT SYSTEM  
EASY TO ASSEMBLE**

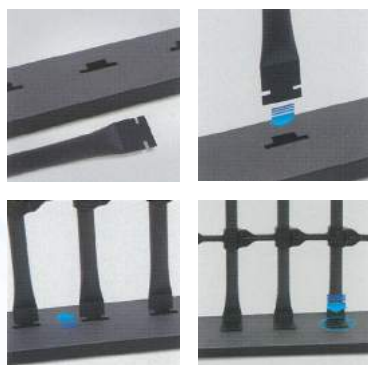

### Technical Specifications

- Self-Assemble
- 2 Person Needed
- Finished: White / Silver Powder Coating
- Headboard, Footboard, Slats and Barriers are knockdown
- Packaging: Polybag & Protector Carton & Assembly Instruction & Outer Carton Box



MODEL SIZE	PIECES IN BOX	PACKAGE WEIGHT 1	PACKAGE WEIGHT 2	PACKAGE SIZE 1	PACKAGE SIZE 2	PCS / 20"FT	PCS / 40"FT	TRUCK
90 x 190 CM	1 IN 2	5,25 KG	14,15 KG	12x6x193 CM	9x76x97 CM	340	820	1030
90 x 200 CM	1 IN 2	5,40 KG	14,15 KG	12x6x202 CM	9x76x97 CM	330	815	1020
140 x 190 CM	1 IN 2	7,25 KG	22,40 KG	12x9x193 CM	9x76x147 CM	215	530	670
140 x 200 CM	1 IN 2	7,60 KG	22,40 KG	12x9x202 CM	9x76x147 CM	210	520	660
160 x 200 CM	1 IN 2	7,60 KG	23,80 KG	12x9x202 CM	9x76x167 CM	190	470	600





SCAN  
for product  
video



**METAL  
BUNK BED**

**IBIZA**



**NEW SLAT SYSTEM  
EASY TO ASSEMBLE**

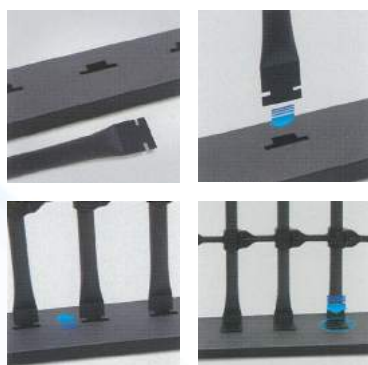

### Technical Specifications

- Self-Assemble
- 2 Person Needed
- Finished: White / Silver Powder Coating
- Headboard and Footboard is welded
- Slats are knockdown
- Packaging: Polybag & Protector Carton & Assembly Instruction & Outer Carton Box



MODEL SIZE	PIECES IN BOX	PACKAGE WEIGHT 1	PACKAGE WEIGHT 2	PACKAGE SIZE 1	PACKAGE SIZE 2	PCS / 20"FT	PCS / 40"FT	TRUCK
90 x 190 CM	1 IN 2	5,00 KG	17,30 KG	13x7x194 CM	8x48x97 CM	510	1100	900
90 x 200 CM	1 IN 2	5,15 KG	17,30 KG	13x7x202 CM	8x48x97 CM	500	1090	890
140 x 190 CM	1 IN 2	7,00 KG	26,75 KG	13x9x194 CM	8x48x145 CM	360	725	600
140 x 200 CM	1 IN 2	7,25 KG	26,75 KG	13x9x202 CM	8x48x145 CM	350	715	590
160 x 200 CM	1 IN 2	7,25 KG	30,00 KG	13x9x202 CM	8x48x165 CM	330	645	520

**milenyum metal**





metal storage cart  
studydesk

*cloth dryer*

mop holder  
studydesk

other products

mop holder

metal storage cart

studydesk

cloth dryer

other products







# CLOTH DRYER



## CLOTH DRYER-1

Sturdy and Durable Cloth Dryer  
 Height of product:106,00cm  
 Width of product:54,50cm  
 Deep of product:35,90cm  
 Finished: White Colour  
 Packaging: Shrink wrap with colour label & outer carton box



## CLOTH DRYER-2

Sturdy and Durable Cloth Dryer  
 Height of product:106,00cm  
 Width of product:79,50cm  
 Deep of product:35,90cm  
 Finished: White Colour  
 Packaging: Shrink wrap with colour label & outer carton box

MODEL	PRODUCT HEIGHT	PACKAGE WEIGHT	PIECES IN BOX	PACKAGE SIZE	PCS / 20"FT	PCS / 40"FT	TRUCK
CLOTH DRYER-1	106 CM	10,40 KG	5	54x57x50 CM	900	2250	2700
CLOTH DRYER-2	106 CM	13,00 KG	5	54x82x50 CM	640	1550	1900



# MOP AND HOLDER









Mop and Broom Holder,  
Made from Plastic  
5 Auto Adjust Slots, 6 Hooks,  
Easy Install Wall Mount,  
Tools Hanger for Kitchen, Garden, Garage, Laundry Room, Office,  
Holds up to 45 Lbs  
Finished: Dark Blue / Silver / Black Color  
Packaging: Single Carton Box & Outer Carton Box

# METAL STORAGE CART



Made from Steel  
 3 x Shelves  
 Height: 76,40cm  
 Width: 45,50cm  
 Deep: 32,00cm  
 3 x Baskets - 30,00 x 41,20cm Inner Size  
 Metal Handle and Plastic Wheel  
 Finished: White / Silver / Black Powder Coating  
 Packaging: Assembly Instruction & Outer Carton Box

						
PACKAGE HEIGHT	PACKAGE WEIGHT	PIECES IN BOX	PACKAGE SIZE	PCS / 20"FT	PCS / 40"FT	TRUCK
76,50 CM	5,70 KG	1	33,5x45,5x15,5 CM	1335	3120	3600



## BOOKCASE 001



Metal & Wooden Combined Book Case

Wooden Parts are Brown Colour.

Metal Parts are Black Colour.

Dimension of Product: 34,50 x 90,00 x 190,00 cm.

Wooden Parts thickness is 18mm.

Metal Parts diameter is 25x25mm.

Metal parts and Wooden parts are packed separately. Totally 2 carton boxes contains 1 product.

With Assembly Instruction.

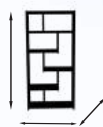

MODEL SIZE  
34 x 90 x 190 CM



PIECES IN BOX  
1 IN 2



PACKAGE WEIGHT  
18,95 KG  
17,60 KG



PACKAGE SIZE  
192,5 x 92 x 7,5 CM  
92 x 36 x 12 CM



PCS / 20"FT  
165

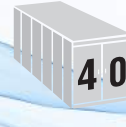

PCS / 40"FT  
375



TRUCK  
460

## BOOKCASE 002



### Metal & Wooden Combined Book Case

Wooden Parts are Brown Colour.

Metal Parts are Black Colour.

Dimension of Product: 30,00 x 90,00 x 190,00 cm.

Wooden Parts thickness is 18mm.

Metal Parts diameter is 25x25mm and 10x30mm..

Metal parts and Wooden parts are packed separately. Totally 2 carton boxes contains 1 product.

With Assembly Instruction.



**MODEL SIZE**  
30 x 90 x 190 CM



**PIECES IN BOX**  
1 IN 2



**PACKAGE WEIGHT**  
9,95 KG  
14,65 KG



**PACKAGE SIZE**  
191 x 36,5 x 7 CM  
91 x 30,5 x 9,7 CM



**PCS / 20"FT**  
370



**PCS / 40"FT**  
860



**TRUCK**  
820



## STUDYDESK 001



### Metal & Wooden Combined Study Desk

Wooden Parts are Brown Colour.

Metal Parts are Black Colour.

Desk Size is 60,70 x 124,00 cm.

Desk Height is 75,00cm. Shelf Height is 160,00cm.

Wooden Parts thickness is 18mm.

Metal Parts diameter is 25x25mm.

Metal parts and Wooden parts are packed separately. Totally 2 carton boxes contains 1 product.

With Assembly Instruction.



**MODEL SIZE**  
60,5 x 124 x 160 CM



**PIECES IN BOX**  
1 IN 2



**PACKAGE WEIGHT**  
18,95 KG  
17,60 KG



**PACKAGE SIZE**  
163,5 x 37 x 7 CM  
127 x 63,5 x 6 CM



**PCS / 20"FT**  
310



**PCS / 40"FT**  
720



**TRUCK**  
720

## STUDYDESK 002



Metal & Wooden Combined Study Desk  
 Wooden Parts are Brown Colour.  
 Metal Parts are Black Colour.  
 Desk Size is 60,00 x 139,50 cm.  
 Desk Height is 75,00cm. Shelf Height is 119,00cm.  
 Wooden Parts thickness is 18mm.  
 Metal Parts diameter is 25x25mm and 10x30mm.  
 Metal parts and Wooden parts are packed separately. Totally 1 carton box contains 1 product.  
 With Assembly Instruction.

						
MODEL SIZE	PIECES IN BOX	PACKAGE WEIGHT	PACKAGE SIZE	PCS / 20"FT	PCS / 40"FT	TRUCK
60 x 139,5 x 119 CM	1 IN 1	25,00 KG	140 x 66,7 x 8,20 CM	370	860	860



# NOTES

A series of horizontal dotted lines for taking notes, spanning the width of the page.

# milenyum metal



[www.palm.com.tr](http://www.palm.com.tr)





**milenyum metal**

**MİLENYUM METAL DIŞ. TİC. ve SAN. A.Ş.**

8th Street No:9 Kayseri Free Zone 38070 Kayseri / TURKEY

Tel. +90 352. 311 44 54 Faks +90 352. 311 34 17

[www.palm.com.tr](http://www.palm.com.tr) - [export@palm.com.tr](mailto:export@palm.com.tr)